



September 20, 2009

Dear Exhibitor(s):

The 2009 Jackson County Youth Fair will be held at the Brackenridge Main Event Center (MEC) located at 284 Brackenridge Parkway, Edna, Texas. With the new venue, there are additional rules and guidelines for the poultry and livestock divisions. Per the general rules, we are notifying exhibitors in writing to reflect the new requirements. Enclosed are the additional rules and guidelines, map of the MEC, and traffic flow map to follow for Wednesday (October 7, 2009) show date.

Please read over the additional rules and guidelines for changes have been made and will be enforced. These are in addition to the existing general rules. If you have any questions, please contact your division chairman. Additional information about the fair can be found online at www.jcyf.org.

We strive to make this 60th Anniversary of the Jackson County Youth Fair a memorable and successful year. Thank you for your cooperation and we will see you at the Fair.

Sincerely,

A handwritten signature in blue ink, which appears to read "Dee Darilek", is written over a horizontal line.

Dee Darilek
President

Jackson County Youth Fair Association

2009
Jackson County Youth Fair
Additional Rules & Guidelines for Poultry and Livestock Entries

- **No Clean Up Day(s):** There will be no mandatory cleanup day requirements before, during, and after the fair. However, we encourage exhibitors to maintain their pen areas throughout the Fair week and help keep the grounds clear of litter.
- **See diagram** for information where to unload your Fair project. Please arrive at your designated area on time and not sooner or later. No projects are allowed in the pen area until weighed on the scale (Livestock Entries) or placed by the Judge (Poultry and Rabbit Entries). You must be in line within your unload time slot and weigh-in to be eligible for the show.

Swine projects unload from **8:00 – 9:00 a.m.**

Lamb projects unload from **9:30 – 10:00 a.m.**

Goat projects unload from **10:00 – 10:30 a.m.**

Steer projects unload from **10:30 – 11:00 a.m.**

Fryers and Rabbits arrive **by 8:00 a.m.** to their designated areas

Turkeys arrive **by 9:30 a.m.** to their designated areas

Notice that trailer traffic must allow for two lanes of traffic. Incoming traffic must stay to left side of roadway. Once livestock entries are unloaded, trailers are asked to follow the “purple line” to unload feed and supplies at stall area and to park in designated trailer parking area. **NO Trailer Parking in main BRC Front Parking Lots.**

- Animals must stay within the Fair Area and Main Event Arena once delivered. **No** animals will be allowed in the Bleachers, Commons Area, and Food Court Areas.
Poultry and Rabbit Shows - The Main Event Arena is limited to exhibitor and exhibitor’s helper(s). All other spectators must utilize bleachers during the show.
Livestock Shows – Exhibitor’s and Committee members are the only persons allowed in show arena. All spectators must view show from bleachers.
- The initial pen of wood shavings will be provided by the Fair. All pens are required to have wood shavings. Any additional shavings needed must be purchased at the BRC Office for **\$6.00/bag**. All exhibitors will be responsible for keeping pens clean. Committee Chairman will monitor pens as to if additional wood shavings are required. Carts will be available to haul off waste material to designated areas. It is the responsibility of all exhibitors to keep the aisles in between pens clean.
- Each Exhibitor will receive a packet upon arriving to the show with their projects. Livestock entries will receive their packets at the scale area and Poultry and Rabbit entries will receive their packets on the Main Event Arena floor. If you do not receive your packet, check with the information booth. There will be a table in the Fair Area to fill out your Project Identification Sign before hanging. Packets will consist of the following:
 - Exhibitor’s ID Tag (allows exhibitor free entrance into the Fair)
 - 2009 Fair T-Shirt (sizes are per your entry form)
 - Project Identification Sign (with two zip ties to hang on pen)
 - Exhibitor Number (to be worn on back while showing your project, with two safety pins)

- **Feeding:**

Gates around the Fair Area will be locked for animal security and liability reasons. All feed, hay, and supplies needed for the remainder of the week must be brought with you on Wednesday. You will be assigned a stall to store these items. You will drop off your feed and supplies after your exhibit is unloaded. Family and/or other groups must share stalls due to limited availability. Locks are permitted and mark your items clearly. Tuesday and Wednesday will be the only time **vehicle traffic** will be allowed around the Fair Area. Security and Liability reasons limit the access of vehicle traffic for the remainder of the Fair week. Carts and/or buggies are available to move feed to and from the stall area. You may park in the front parking lot and walk through the gates next to the concession stands for access to the Fair Area.

Free gate access is available until 4 p.m. Wednesday through Friday and until 10 a.m. on Saturday of the Fair week. After these times you must have an exhibitor tag, pass, or a ticket to get through the gates. No exceptions!

- **Show Steer Boxes:**

Steer boxes can be brought in on Tuesday from 8:00 am thru 8:00 pm. Steer boxes are allowed on outside fence of where steers are tied. Keep boxes as close to fence as possible to keep driveway clear. Please secure and mark your property.

- **Pick Up of Animals:**

Same flow of trailer traffic will be utilized for Sunday's pick up of animals. Poultry and Rabbit projects will be allowed to park in front parking lot and pack projects from the Livestock Area to the parking lot. Please do not block roadways.

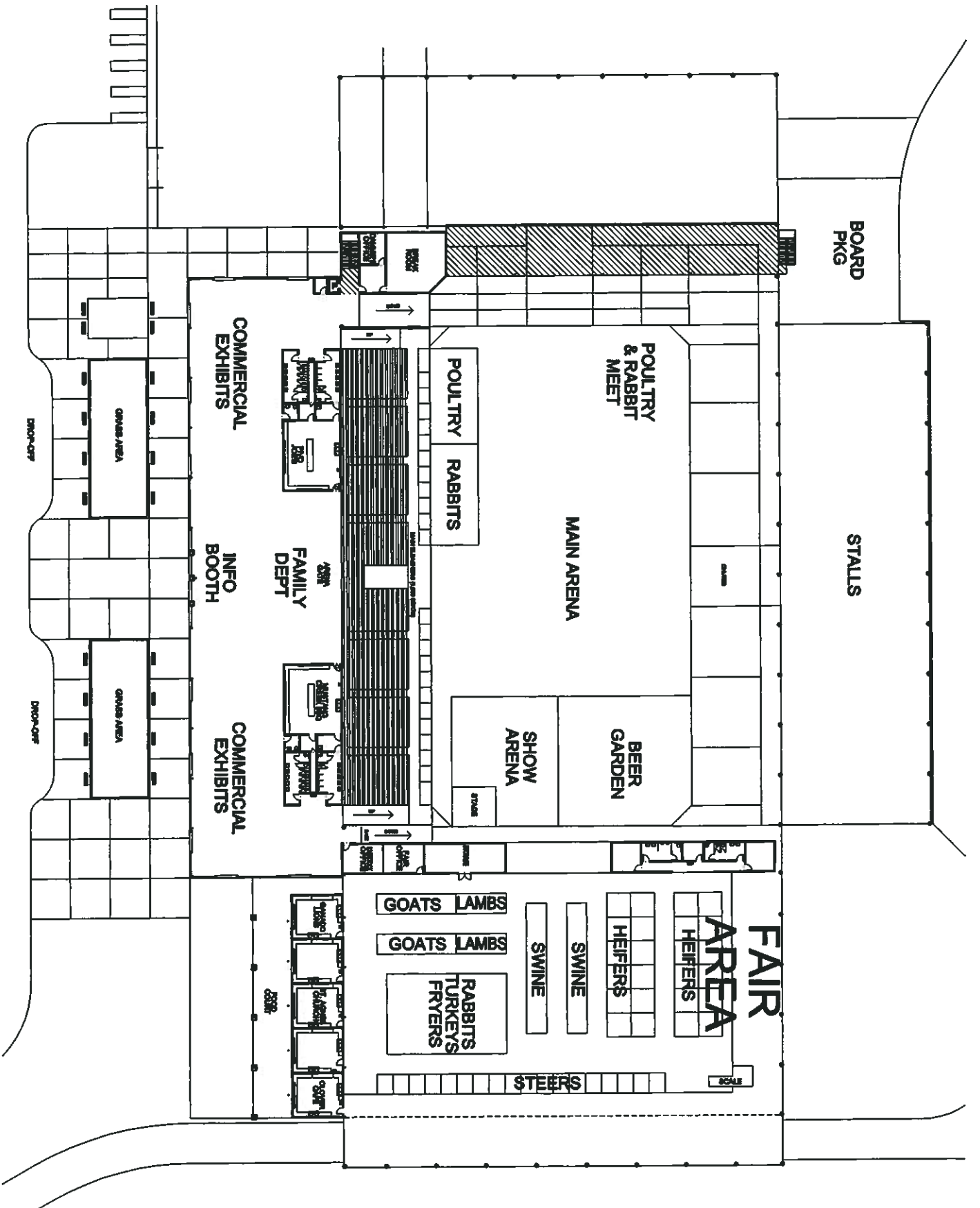

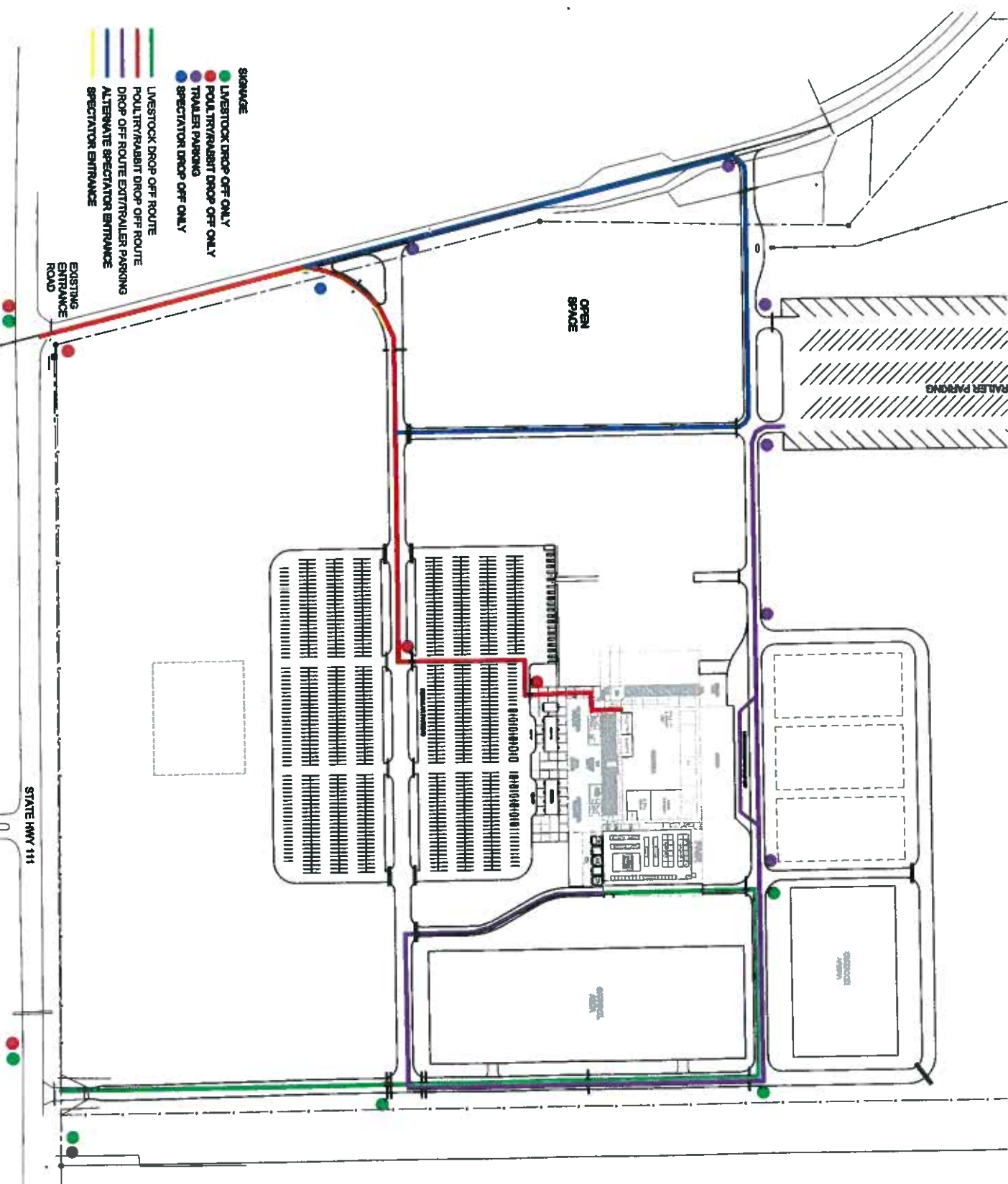

LAKE TEXOMA STATE PARK